



## Year 6 Open Evening 2021 Programme



## Welcome to Outwood Academy Normanby Y6 Opening Evening

- 5.45pm      Arrival
- 6.00pm      Principal's address to parents and students in our main hall.
- 6.30pm      Please follow your group tour guide on your directed route- collect stamps in your passport as you go. Drop them into the box on exit for your chance to win an echo dot!

*If you wish to visit Outwood Academy Normanby during the course of the school day, please do so, and a member of the Senior Leadership Team will be delighted to show you around our academy during lesson time. Please contact Debbie Smith, Principal's PA via [d.smith@normanby.outwood.com](mailto:d.smith@normanby.outwood.com) if you would like to take up this opportunity.*

### **Useful contacts and information**

Remember that the closing date for applications to a place at R&C Secondary Schools is 31 October 2021. It is important whichever school you choose for your child, not to miss this deadline. We hope you and your child will join us at Outwood Academy Normanby, and thus the Outwood Grange Family of Schools. We do feel our proven track record of academic excellence, support and extra-curricular opportunities, in a warm, supportive environment will benefit your son/daughter a great deal during his/her time at secondary school.

Application forms should be returned to: Schools Admissions, Redcar & Cleveland Borough Council, R&C House, Kirkleatham Street, Redcar, TS10 1RT  
More details are here: [www.redcar-cleveland.gov.uk](http://www.redcar-cleveland.gov.uk) and search for admissions

For queries regarding Educational Needs, please contact Miss Elizabeth Mitchell, SENDCo via [e.mitchell@normanby.outwood.com](mailto:e.mitchell@normanby.outwood.com) or 01642 454577

For queries regarding Free School Meals, please contact Mrs Debbie Smith via [d.smith@normanby.outwood.com](mailto:d.smith@normanby.outwood.com) or 01642 454577.

We do hope you have a great evening tonight, and have most, if not all of your questions and queries answered. You can follow the progress of the school via our Twitter account @OutwoodNormanby or by 'Liking' us on Facebook: Outwood Academy Normanby.

Our website has lots of information and news about the school, and is regularly updated. Please have a visit here [www.normanby.outwood.com](http://www.normanby.outwood.com) There is specific information about our admissions here: [www.normanby.outwood.com/admissions](http://www.normanby.outwood.com/admissions)

Departments & Key Staff		
Principal- Mr Wappat Vice Principals- Mr Young and Mrs Beaumont Assistant Principals- Miss Gibson, Miss McDonnell Associate Assistant Principals- Mrs Ritchie, Mrs Murphy, Mrs Rowe, Mrs Dodsworth Learning Managers- Mrs Laverick, Mrs Rowe, Mrs Jackson, Mr Hughes		
Department	Room	Key Staff
English	EN6	Mrs Jackson (HoD) Mrs Osborne Mrs Rees Miss Hall Miss Mitchell Mr Crosby Mrs Beaumont Miss Sanderson
Maths	MA4	Mrs Charlton (HoD) Mrs Murphy Mr Morgan Mrs Robson Mrs Hardy Ms McDonnell
Science	SC2	Mr Savage (HoD) Mrs Day Miss Hayes Mrs Norton Mrs Longster
Humanities- History	HUM3	Miss Firby Mr Dunn
Humanities- Geography	HUM4	Mrs Storey (HoD) Miss Graham
Modern Foreign Languages	LA2	Mrs Ritchie (HoD) Mrs Thynne
Technology- D&T	TE2	Mrs Hendry (HoD) Mr Robinson
Technology- Catering	TE3	Miss Tann
Creative Arts- Art	AR1	Ms Metcalfe (HoD)
Creative Arts- Music	MU1	Mrs Dodsworth
Creative Arts- Drama	DR1	Mrs Wray
Sport	Sports Hall	Mr Dacombe (HoD) Miss Dauber Miss Limon
Computer Science	IT2	Mr Pratt

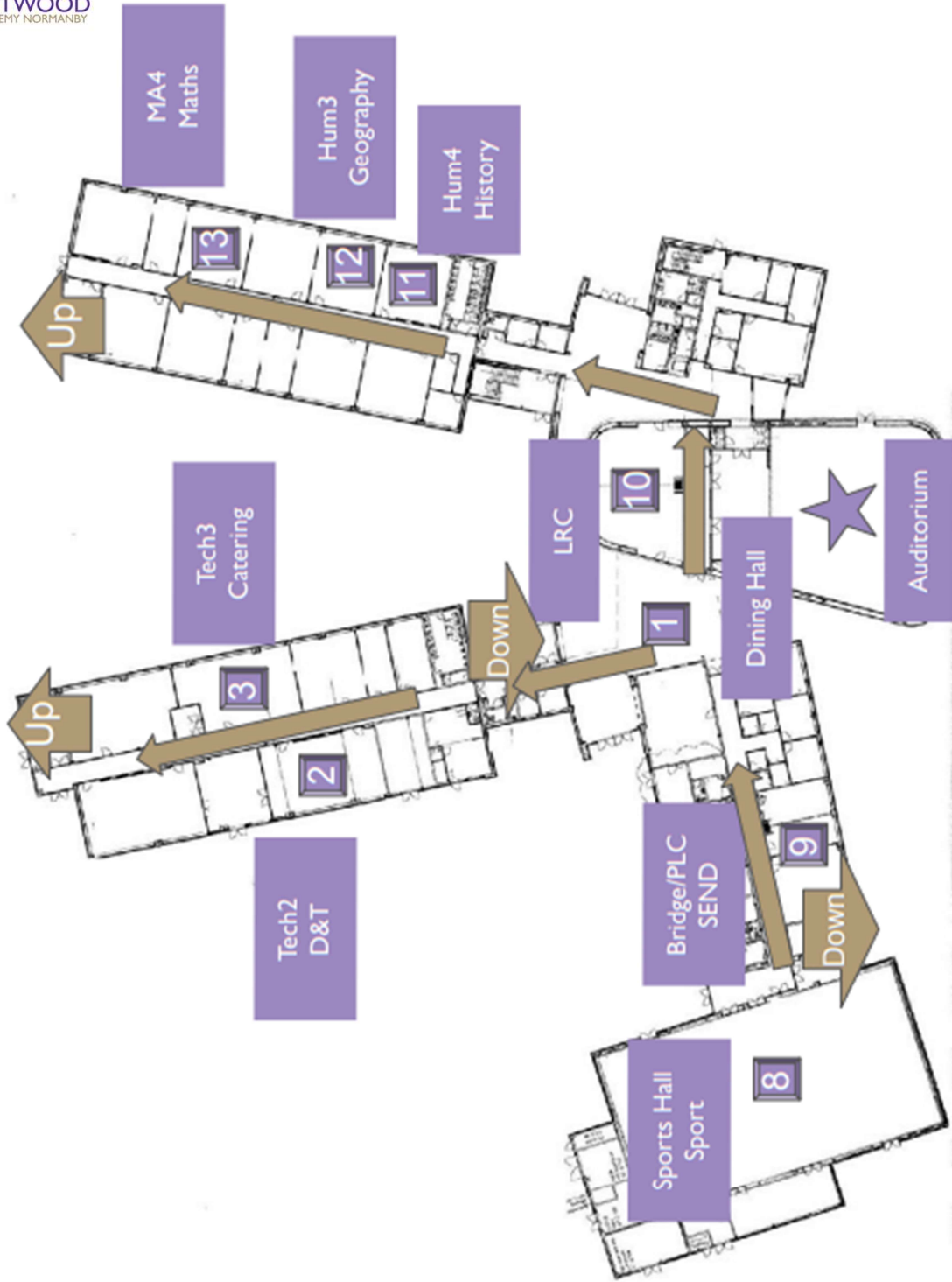

Downstairs

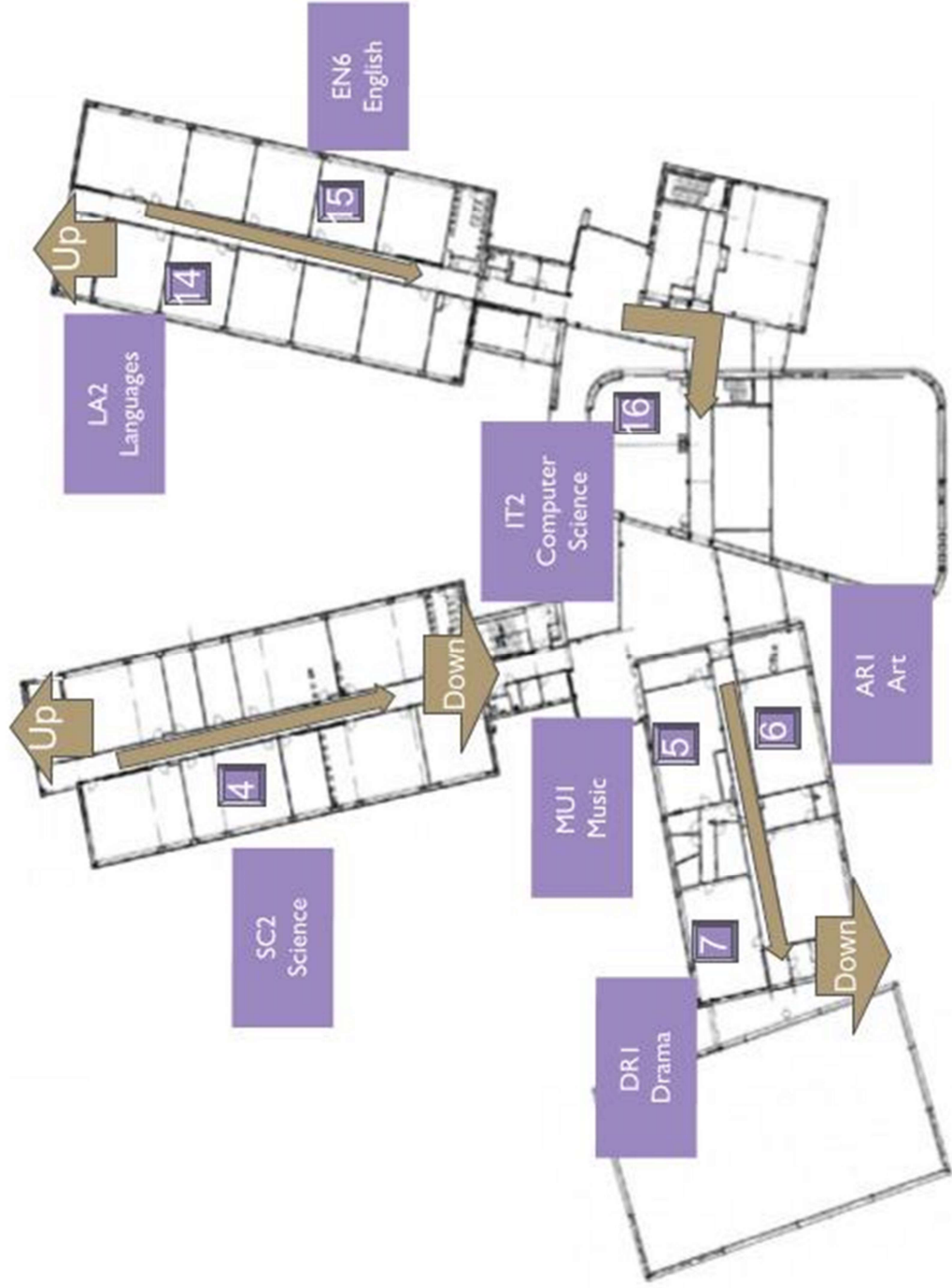

Upstairs



# Free Uniform!

We issue every Year 7 student, on arrival in September each year, a free uniform and PE kit.

- **Outwood Blazer & Tie**
- **Two white shirts**
- **Outwood Trousers or Outwood Skirt**
- **PE polo shirt**
- **PE reversible rugby shirt**
- **PE shorts**
- **PE socks**

We ask for parent support that when blazers, trousers or skirts are grown out of, you buy the official Outwood replacements from Trutex online or Bambini's in Guisborough

# An example of our impact on GCSE Results

% GCSE 9-4 in both English and Mathematics 2018-2021

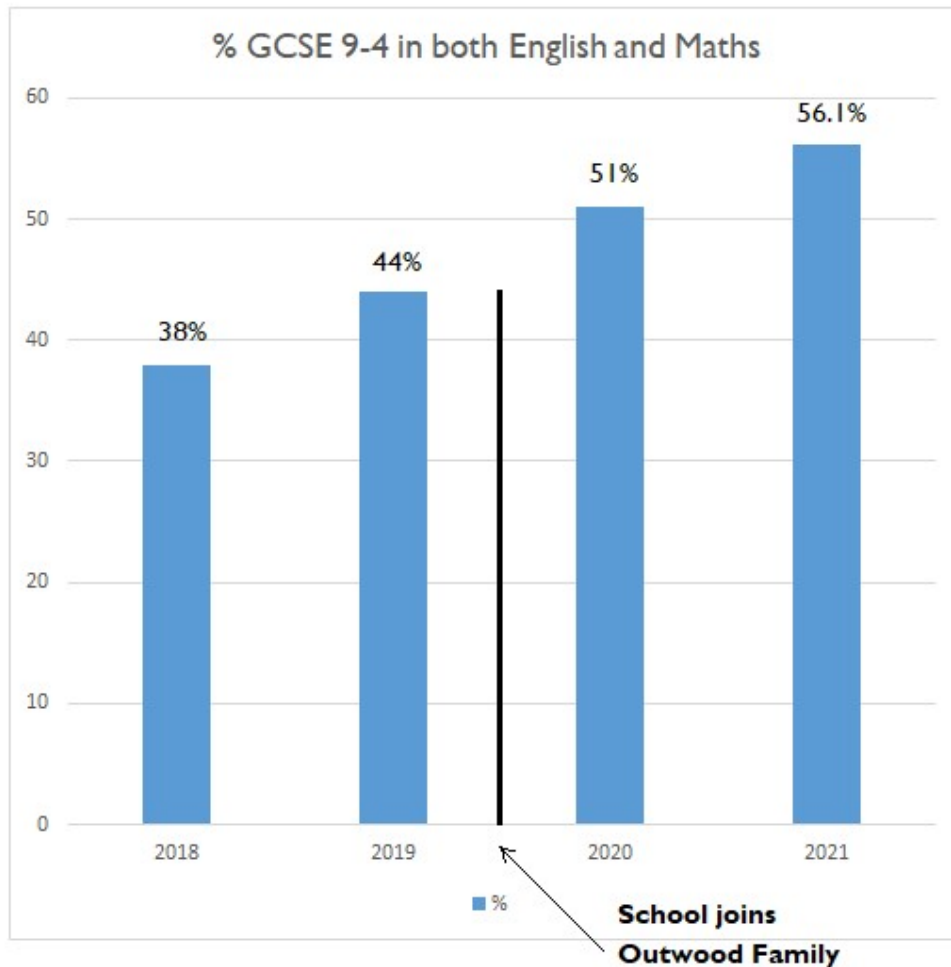

Every child has a right to an outstanding education, and at Outwood Academy Normanby we are determined to provide it. We aim to ensure our young people leave with the very best qualifications they are capable of. We also nurture their talent, confidence, resilience and work-ethic, aiming to truly widen their access to post-16 courses and future careers, where we hope they will feel fulfilled and make a real difference to Teesside, Britain and beyond. Come and visit any time!

**Students First—Raising Standards, Transforming Lives**

## LESSON TIMES

<b>Tutor</b>	8.25am – 8.45am <i>(Students to be on site by 8.20am)</i>
--------------	--

<b>Period 1</b>	8.45am – 9.45am
-----------------	-----------------

<b>Period 2/ Break</b>	9.45am – 11.00am
----------------------------	------------------

<b>Period 3</b>	11.00am – 12.00pm
-----------------	-------------------

<b>Period 4/ Lunch</b>	12.00pm – 1.30pm
----------------------------	------------------

<b>Period 5</b>	1.30pm – 2.30pm
-----------------	-----------------

Enrichment – 2.30pm – 3.30pm
------------------------------